



DEFY GRAVITY



JOBST® COMPRESSION

Compression Bandages

CONTENTS

Compression Bandages

JOBST® COMPRILAN® JOBST® COMPRILAN® S	168
JOBST® COMPRI2 JOBST® COMPRI2 LITE	169
APPLICATION TECHNIQUES	170

JOBST® COMPRILAN® JOBST® COMPRILAN® S

100% Cotton Short-Stretch Compression Bandage

Comprilan® can be used for phlebology and lymphatic indications to support the muscle pump action and improve the haemodynamics of venous return. This short-stretch bandage provides high working pressure and low resting pressure. It is durable and extremely resistant for a cost-effective treatment with easy reapplication.

- Washable and re-usable up to 10 times
- Air permeable
- Bandage ends do not fray

INDICATIONS:

- Lymphoedema
- Venous ulcers
- Venous oedema
- Thrombophlebitis
- Post sclerotherapy

COMPRILAN®

Product Code	Size	Pack Quantity
01026-00	6 cm x 5 m	1 Roll
01027-00	8 cm x 5 m	1 Roll
01028-00	10 cm x 5 m	1 Roll
01029-00	12 cm x 5 m	1 Roll



COMPRILAN® S*

Product Code	Size	Pack Quantity
75078-00	6 cm x 5 m	10 Rolls
75079-00	8 cm x 5 m	10 Rolls
75080-00	10 cm x 5 m	10 Rolls
75081-00	12 cm x 5 m	10 Rolls



Compression dosage is dependent on the method of application.

* Comprilan S has no metal clips

JOBST® COMPRI2 JOBST® COMPRI2 LITE

Two-Layer Compression Bandage System

JOBST® Compri2 and Compri2 Lite have visible guidance tools to aid application and promote the correct compression. Two compression levels, ensuring the right level can be selected for both venous and mixed aetiology leg ulcers. Intended for single use with up to 7 day wear time.

- Short-stretch, graduated compression layer
- Soft, air permeable padding layer
- Bandage ends do not fray

INDICATIONS:

- Lymphoedema
- Venous leg ulcers

Type of Disease	Incidence	ABPI	Compression Level	
Venous	~ 60%	>0.8	30-40mmHg	JOBST® Compri2
Mixed aetiology	~ 20%	0.5-0.8	20-30mmHg	JOBST® Compri2 Lite
Arterial	~ 20%	<0.5	No compression	-



1st Layer

- Application around the heel becomes much easier because the bandage stretches and conforms
- Tearable to allow extra padding to be easily applied where necessary

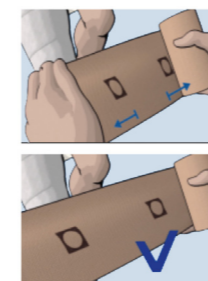
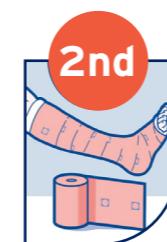

2nd Layer

- A simple indicator to assist achieving the correct compression level every time
- The bandage can be adjusted during application



Product Code	Type	Compression Level	Size	Pack Quantity
76271-01	Compri2	30-40mmHg	10 cm x 7.5 m	1 Kit
76271-05	Compri2	30-40mmHg	10 cm x 7.5 m	6 Kits
76271-03	Compri2 Lite	20-30mmHg	10 cm x 7.5 m	1 Kit
76271-07	Compri2 Lite	20-30mmHg	10 cm x 7.5 m	6 Kits

Comprilan® and Comprilan® S

Upper Limb Application Technique

Product Code	Product	Width	Quantity
72026-02	Protouch® Stockinette	7.5 cm	1 Length
71961-01	Easifix® Bandage	2.5 cm	1 or 2 Rolls
73048-00	Artiflex® Soft	7.5 cm	1 or 2 Rolls
01026-00	Comprilan® (or Comprilan® S)	6 cm	1 Roll
01027-00	Comprilan® (or Comprilan® S)	8 cm	1 or 2 Rolls
01028-00	Comprilan® (or Comprilan® S)	10 cm	1 or 2 Rolls



1 Before applying the bandages, ensure good skin care has taken place.



2 Measure the Protouch® Stockinette to be used as protection by measuring the length of the total arm from fingers to shoulder tip.



3 Apply the Protouch® Stockinette to the length of the arm, allowing a small hole for the thumb.



4 To bandage the fingers, start an anchor at the wrist with a gauze bandage.



5 Coming from the wrist, make approximately two turns around the finger with light tension before returning over the back of the hand. Ensure you leave the finger tips free.



6 Secure each finger bandage with an anchor around the back of the hand.



7 The completed finger bandages should be on the dorsum of the hand, leaving the palm free.



8 Pad the limb with Artiflex®, starting at the base of the metacarpal heads and leaving a hole for the thumb.



9 Bandage up the limb with 50% overlapping turns.



10 Additional padding may be added for extra protection.



11 Continue applying padding up the limb. It is recommended that a wider size padding is used beyond the forearm.



12 Continue the padding up to the armpit.



13 Start the 6 cm Comprilan® compression bandaging with an anchor at the wrist.



14 The turns run from the back of the hand to the palm, returning to the back of the hand.



15 After one turn across the middle phalanx of the thumb, hold the edge of the bandage down.



16 To prevent pocketing between the thumb and index finger, press down the edge of the previous turn.



17 Repeat this turn once more.



18 After two turns around the hand, the first Comprilan® bandage should end two figures of eight just behind the wrist.



19 The patient presses a clenched fist against the therapist's abdomen and tenses their muscles. 8 cm Comprilan® is started from the wrist.



20 Run in long figures of eight or spirals, using 50% overlap, up to the elbow.



21 Start a new 10 cm Comprilan® and commencing in the opposite direction, in figures of eight or spirals, wrap up the limb, over the elbow and up to the upper arm.



22 Secure the end of the bandage with adhesive tape and roll over the Protouch® Stockinette for protection.



23 Ensure there are no gaps in the bandages to ensure no fluid accumulates in any area not compressed with bandage.

© 2000 Beiersdorf AG Hamburg. Excerpt from the book prepared for publication "Compression therapy - healing with pressure" by Peter D. Asmussen and Brigitte Söllner. Bandaging technique of the Földi-Klinik, Klinik für Lymphologie, D-79856 Hinterzarten, Therapist: Heinz Thoma.

Comprilan® and Comprilan® S Lower Limb Application Technique

Product Code	Product	Width	Quantity
73048-01	Artiflex® Soft	10 cm	1 or 2 Rolls
01027-00	Comprilan®	10 cm	1 Roll



Apply Artiflex® padding from the base of toes to tibial plateau in a spiral configuration. The layers assist in absorbing exudate and to correct any distortions of the natural contours of the leg.



Commence 10 cm Comprilan® compression bandage at the base of the toes, working from inside to outside, with the barrel of the bandage facing upwards.



Keep the tail of the bandage short and apply firmly over the dorsum of the foot maintaining an even tension without overstretching.



Bandage twice around the foot.



Wind bandage over top of foot, cover outside ankle, inside ankle and return back over top of foot and wind under heel.



Instructions as per step 5.



Wrap bandage around inside ankle to outside ankle joint. Ensure heel flap from first bandage is covered.



Continue to wind bandage in a spiral configuration to base of the tibial plateau or two finger width below the knee.



The bandage is applied in a spiral configuration with a 50% stretch and 50% overlap.



Secure bandage with clips or tape e.g. Leukopor® or Leukoplast®. Any excess bandage is placed down the leg without compression.



Compri2 Lite Upper Limb Application Technique



Equipment

Set up with the required equipment (foam is optional to protect bony prominences).

Always include the fingers for an upper limb application. Skin care and wound care first (if applicable).



Fingers

Loose anchor at wrist and then wrap towards the thumb starting distally then going to the proximal base of the thumb.

Finger bandage - Handy® Gauze Cohesive 2.5 cm.



Wrap towards the thenar eminence rather than "around the wrist".



Continue with each finger until each has been individually bandaged.



Finish with "Opera House" pattern.



Compri2 Padding Layer
Measure where to cut thumb hole.



Tuck thumb away first for safety by making a fist and cut a small hole.



Slip the thumb through the opening of the padding. After padding the dorsum of hand, continue to pad the wrist before moving up the limb.



50% overlap up the limb. The area should not be "see through".



Trim excess.



Foam
Trim edges.



Apply foam as an option to ensure protection of the thumb web space.

Product Code	Product	Size	Pack Quantity
76271-03	Compri2 Lite	10 cm x 7.5 m	1 Kit
76271-07	Compri2 Lite	10 cm x 7.5 m	6 Kits
92557-00	Handy® Gauze Cohesive	2.5 cm x 2 m	2 Rolls



13
Compri2 Compression Layer: Hand
Cut a piece of the compression layer that is approximately 8 indicator squares long. Cut to one indicator square from one end.



14
Cut from the opposite end lengthwise, leaving a 2 cm region uncut.



15
Drape over the hand. Apply the first "strap" over the dorsum of the hand.



16
Drape and apply the more distal strap first, followed by the more proximal strap second.



17
Use the second strap over the dorsum and the thenar eminence area. Wrap in a figure 8 pattern to encompass the base of the thumb.



18
Once the hand has been encompassed, continue up to the wrist.



19
Apply a second layer to ensure optimal stiffness is created over the dorsum of the hand.



20
The individual length should be able to complete two rotations around the hand.



21
Compri2 Compression Layer: Arm
Overlap hand compression with a loose anchor. Compress up the limb.



22
To achieve correct pressure, pull from oval to square on the pressure indicator.



23
Maintain the correct tension during application to ensure even compression.



24
Insert elbow pad (optional).



25
Elbow pad is recommended especially for the first application.



26
Finish two fingers from the axillary fold.



27
Test function and comfort and provide safety warnings.



Compri2 and Compri2 Lite

Lower Limb Application Technique



1 Apply toe bandaging if toe or significant dorsal foot oedema is present (for lymphoedema patients).



2 Apply the compression padding with the foot at an angle of 90 degrees. Start by wrapping it around the foot, starting at the base of the toes. Continue wrapping it around the foot, overlapping the padding on the back of the foot so that half of its width covers the ankle.



3 The next turn of the bandage goes over the heel. If necessary, prominent points on the leg can be additionally padded with cut-offs of the padding.



4 Continue bandaging as far as the knee and ensure 50% overlapping. The padding should fit the shape of the limb with minimal stretching.



5 Remove excess material and press the end of the padding on lightly.



6 An indicator on the compression bandage helps to ensure correct tension by changing from an oval to a circle when correct tension is applied.



7 Start by wrapping it around the foot at the base of the toes.



8 Pass it around the ankle in two or three figure of eight, ensuring the heel is completely covered. Ensure the foot is kept at 90 degrees.



9 Continue wrapping the compression bandage around the lower leg, overlapping by at least 50%, keeping the bandage under even tension. The indicator on the bandage will be a circle when the correct tension is applied.



10 Cut off excess bandage material and press the compression bandage on lightly. This will ensure the bandage adheres well to itself and to the padding.

Product Code	Product	Size	Pack Quantity
76271-03	Compri2 Lite	10 cm x 7.5 m	1 Kit
76271-07	Compri2 Lite	10 cm x 7.5 m	6 Kits
76271-01	Compri2	10 cm x 7.5 m	1 Kit
76271-05	Compri2	10 cm x 7.5 m	6 Kits
92557-00	Handy® Gauze Cohesive	2.5 cm x 2 m	2 Rolls

Fibre Content

FABRIC/CCL	Cotton	Nylon (Polyamide)	Polyurethane	Polyester Fibre	Polyester Foam	Non-latex Natural Rubber
JOBST® Comprilan® / Comprilan® S	>98%	<1%	<1%	-	-	-
JOBST® Compri2 / Compri2 Lite: Layer One support fabric 1.5mm thickness	-	-	-	100%	-	-
JOBST® Compri2 / Compri2 Lite: Layer One coating 0.3mm thickness	-	-	-	-	100%	-
JOBST® Compri2 / Compri2 Lite: Layer Two support fabric	92%	<1%	<1%	-	-	-
JOBST® Compri2 / Compri2 Lite: Layer Two coating	-	-	-	-	-	6%



JOBST®, an Essity brand

Always read the label and follow the directions for use.

ESS0804 03/2026

Essity Health & Medical
PO Box 337, Mount Waverley, Victoria, Australia 3149
medical.essity.com.au
jobst.com.au

JOBST® Customer Service AU
T 1300 998 810 F 1300 998 820
JOBST® Customer Service NZ
T 0508 998 810 F 0508 998 820