

# Cutimed® Hydro L

Cutimed® Hydro L is a hydrocolloid dressing designed to maintain a moist wound environment. Cutimed® Hydro L is a flexible dressing.

## Product indication

Cutimed® Hydro L is intended for non to low exuding wounds including superficial burns, donor sites, postoperative wounds, and skin abrasions.

## Product benefits



### Maintains moist wound healing environment

Helps to maintain a moist wound environment and supports moist wound healing.



### Relieves pain during treatment

The dressing is easily removed intact with minor pain for the patient.



### Facilitates autolytic debridement

By releasing moisture, Cutimed® Hydro facilitates autolytic debridement.



## Applications

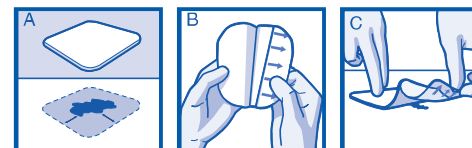

# Cutimed® Hydro L

Ordering Information	Size	Product Code	Pack size	Nappi Code
<b>Cutimed® Hydro L</b> Thin hydrocolloid dressing	5 x 25 cm	72636-34	12	TBA
	7,5 x 7,5 cm	72636-35	10	TBA
	10 x 10 cm	72636-36	10	TBA
	15 x 15 cm	72636-37	5	TBA



**LATEX  
FREE  
FORMULA**



## Icon overview

Improved guidance with symbols	
Exudate	Dry            Low            Moderate            High            Excessive            Low to Excessive
Wound depth	superficial            deep            superficial and deep
Wound state	Infected            Sloughy            Granulating            Epithelializing            Necrotic
Both side application	Not on pack (in IFU only)
Secondary dressing needed	

Find icons here



# Cutimed® Hydro B

Cutimed® Hydro B is a hydrocolloid dressing designed to maintain a moist wound environment. Cutimed® Hydro B is a dressing with a tapered edge and a thicker core than Cutimed® Hydro L.

## Product indication

Cutimed® Hydro B is intended for low to moderately exuding wounds including pressure ulcers, leg ulcers, superficial burns, donor sites, postoperative wounds, and skin abrasions.

## Product benefits



### Maintains moist wound healing environment

Helps to maintain a moist wound environment and supports moist wound healing.



### Relieves pain during treatment

The dressing is easily removed intact with minor pain for the patient.



### Facilitates autolytic debridement

By releasing moisture, Cutimed® Hydro facilitates autolytic debridement.

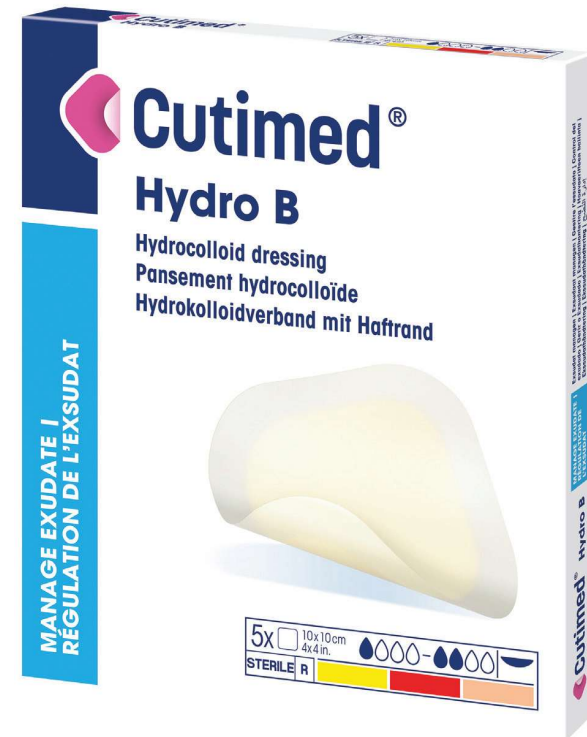

## Applications

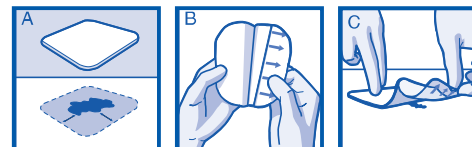

# Cutimed® Hydro B

Ordering Information	Size	Product Code	Pack size	Nappi Code
<b>Cutimed® Hydro L</b> Hydrocolloid dressing with adhesive edge	7,5 x 7,5 cm	72635-33	10	TBA
	10 x 10 cm	72635-34	10	TBA
	15 x 15 cm	72635-35	5	TBA
	15 x 18 cm (Sacrum)	72635-36	5	TBA



**LATEX FREE FORMULA**



## Icon overview

Improved guidance with symbols	
Exudate	Dry            Low            Moderate            High            Excessive            Low to Excessive
Wound depth	superficial            deep            superficial and deep
Wound state	Infected            Sloughy            Granulating            Epithelializing            Necrotic
Both side application	Not on pack (in IFU only)
Secondary dressing needed	

Find icons here

